

Mina Mobile



ASSEMBLY INSTRUCTIONS

The following instructions will guide you through the steps required to assemble your new Mina Mobile.

Please read entire installation guide before beginning installation.

The appropriate hardware kits for each mobile will be packaged with each product.

- Binder Post (x6)
- Binder Screw (x6)
- Protective Sleeve (x6)
- Casters (2 locking, 2 non-locking) Mina Mobile
- Steel legs (x4)

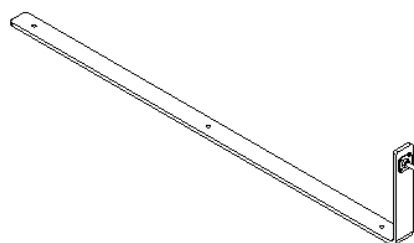
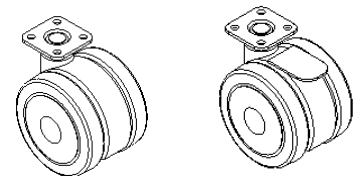
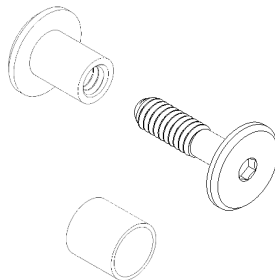

WARNING
Risk of injury to installers and users
Read the entire assembly directions before
beginning assembly.

Mina Mobile

Assembly

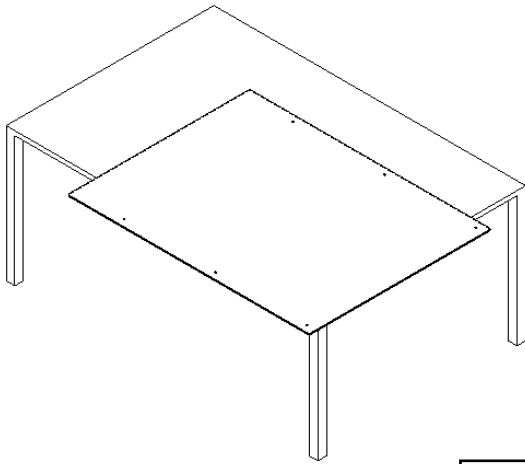

Step 1

Place panel on a clean work bench or table. We recommend you place a blanket or protective cloth to prevent any scratching of the writing surface. Overhang panel to one side of table 3", to allow for leg assembly.

Step 2

Position legs as shown. Join front and back leg to panel using the binder post (3), sleeve (3) and binder Screw (3). Tighten with Allen key (not provided). Do not fully tighten at this point. Repeat for other side.

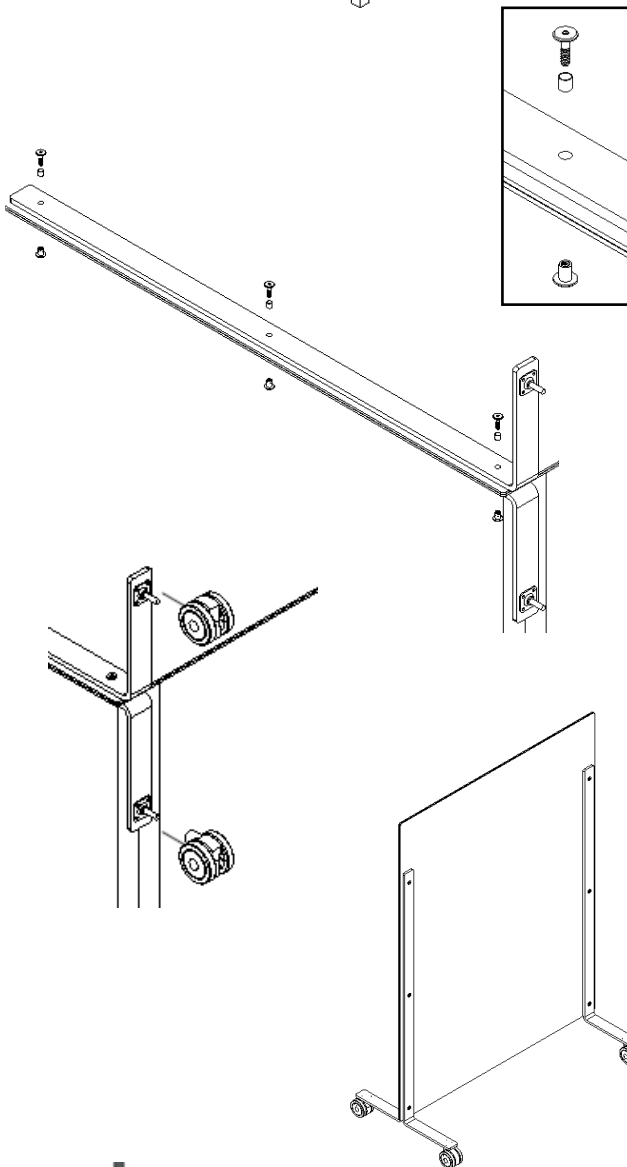

Step 3

The caster stems have been factory install on each leg. Simple press caster hub onto each stem. Two non-braking on one side. Two brake on the other side.

Step 4

With two people, stand mobile up on a flat level surface. Now tighten all 6 binder screws.