



LCS Porcelain Large Format System MW2



INSTALLATION INSTRUCTIONS

Tools Needed:

- Laser/level
- Drill and drill bit
- Screw driver
- Tape measure
- Caulk gun
- Suction cups (recommended)
- If cut outs are needed – jig saw with a metal cutting blade
- Rubber mallet
- Safety glasses

WARNING

Risk of injury to installers and users
Read the entire assembly directions before
beginning assembly.

LCS Porcelain Large Format System - MW2

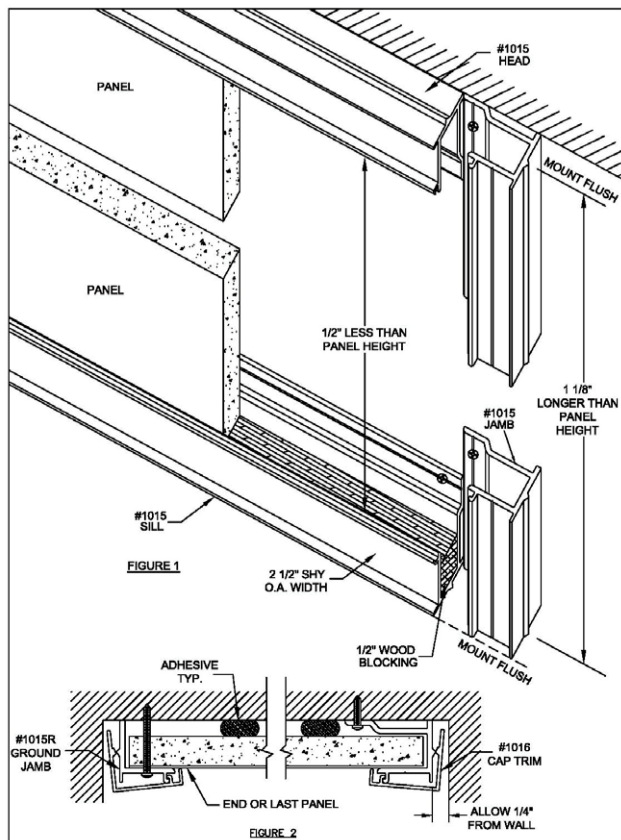

INSTALLATION

1. Install No. 1015 Ground Sill maintaining $1/4''$ space above floor (or base board, if already installed). Cut sill $2-1/2''$ shy of overall width of installation, allowing $1-1/4''$ on each side. Insert $1/2''$ blocking. (See Figure 1) Make sure sill is level.
2. Install No. 1015 Ground Jamb starting from either side. Align jamb corner with sill corner. Make sure it is plumb. Note: Jamb must be $1-1/8''$ longer than panel height.
3. Install No. 1015 Ground Head maintaining $1/4''$ from ceiling. Cut shy $2-1/2''$ of overall width and mount inside jamb. Note: Overall opening height must be $1/2''$ shorter than panel height. (See Figure 1)
4. If wall-to-wall installation, allow $1/8''$ to $1/4''$ space so No. 1016 Trim can be snapped into place.
5. Apply egg-size gobs of adhesive to back of first panel, staggered on approximate $12''$ grid. Install panel by inserting into head trim, swinging bottom of panel over sill trim and setting down onto blocking. Adjust panel sideways to fit inside jamb trim. Compress glue to flush panel face and adjust so open side is plumb.
6. Repeat with additional panels, using chosen joint connection, until all panels are installed. Note: If wall to wall, place 1015R Ground Jamb into panel and apply to wall together.
7. After all panels are installed, screw No. 1015R Ground Jamb, through panel into wall. (Note: Over-tightening screws may cause panel to bow.) Cap both jambs with No. 1016 Trim. Note: No. 1016 Trim must be cut $1/4''$ longer than No. 1015 Jamb. Then, cut No. 1016 Trim for head and sill to fit between jambs. (See Figure 2)



LCS Porcelain Large Format System MW3



INSTALLATION INSTRUCTIONS

Tools Needed:

- Laser/level
- Drill and drill bit
- Screw driver
- Tape measure
- Caulk gun
- Suction cups (recommended)
- If cut outs are needed – jig saw with a metal cutting blade
- Rubber mallet
- Safety glasses

WARNING

Risk of injury to installers and users
Read the entire assembly directions before
beginning assembly.

LCS Porcelain Large Format System - MW3

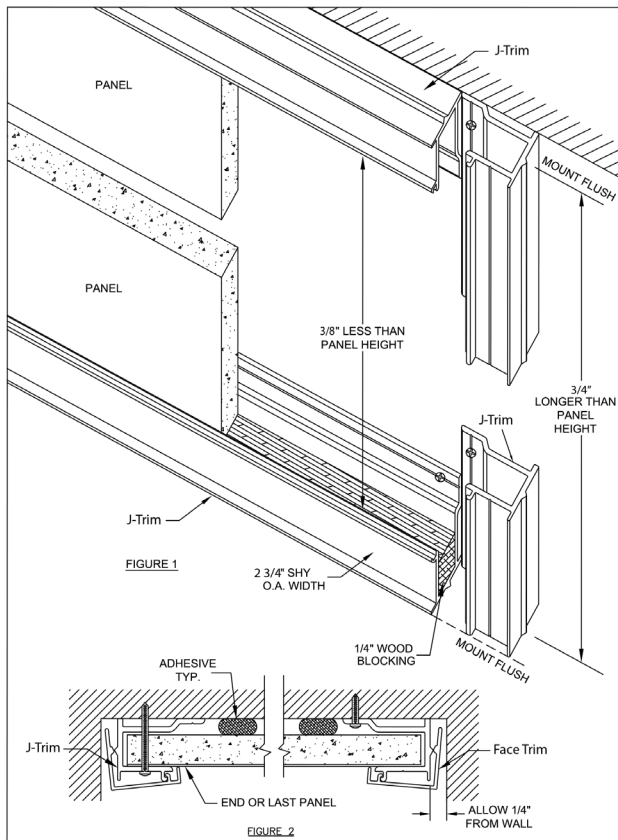

INSTALLATION

Note: Throughout installation, be sure to allow a $\frac{1}{4}$ " spacing around perimeter of J-trim, this will allow your top trim to snap in place.

1. Install bottom J- trim, cut $2\frac{3}{4}$ " less than overall width, make sure bottom J-trim is level and insert $\frac{1}{4}$ " wood blocking provided. (see figure 1)
2. Install J-trim from either side aligning side trim with the bottom of the bottom J-trim. Make sure it is plumb. Note: side trim must be $\frac{3}{4}$ " longer than panel height.
3. Install top J-trim with the top of your side trim. Cut top trim the same length of your bottom trim. Note: overall opening height must be $\frac{3}{8}$ " shorter than panel height. (see figure 1)
4. Apply egg-size globs of adhesive to the back of the first panel, in a 1' grid pattern. Install panel by inserting into the top J-trim, swinging bottom of panel over bottom J-trim and setting down onto blocking. Adjust panel sideways to fit inside side trim. Compress panel to wall to ensure bonding between panel and wall, making sure your panel is plumb.
5. Repeat with additional panels, using chosen joint connection, until all panels are installed. If using a Spline Bar for the joint, secure to the wall by putting adhesive on the back of the spline or screw it to the wall, being sure not to over tighten. Over tightening can lead to the spline twisting. Note: On last panel of wall to wall application, it will be necessary to add side J-trim onto panel, and install both, panel and J-trim at the same time.
6. After last panel is installed, secure last piece of J-trim to wall by screw through J-trim and panel into wall. Note: Be sure not to overtighten so that trim reveal stays consistent.
7. If you are using a Spline Bar for the joint, we strongly suggest you shore up spline joint. In order to shore spline joints, cut 2x4 the height of your unit. Securing 2x4 to top and bottom J-trim by screwing through 2x4 into trim and panel (holes will be later concealed with face trim). Insert shims at any high spots along the joint so that the joint is flush. The joint should not overlap or have high or low spots. Allow adhesive to properly cure, and then remove 2x4s and shims.
8. At this point, to finish the unit, apply face trim. When applying face trim, always start with the ends. Cutting side face trim $\frac{3}{16}$ " longer than the side J-trim installed previously. Then cut the face trim for bottom and top to fit between the side face trim.